

Charlton Kings Community Players



# “The Rivals”

by Richard Brinsley Sheridan

Produced and Directed by Martyn Fry and Tony Jeans

**Thursday 24th, Friday 25th &  
Saturday 26th October 2013**

7.30pm

St Edward's School, Cirencester Road, Performance Hall

Tickets at £7.50 for adults and £5 for children aged 16 or under are available from  
Blend Coffee Shop, Charlton Pharmacy and Second Wind  
or phone 01242 524715 or 517719

Find more details on the Players' web site <http://www.charltonkingscommunityplayers.com/>

## **Photo Storybook of the Production and related activities**



*Publication copyright  
Charlton Kings Community Players  
Editor: Sandra Jeans*

<http://www.charltonkingscommunityplayers.com/>

# Programme - Designed by Andrew Laver

## Production Team

Martyn Fry and Tony Jeans.....	Producers and Directors
Jane Jones.....	Production Manager
Fiona Connor.....	Production Administrator
Derek Palmer.....	Stage Manager (CKCP Treasurer)
Peter Ryan and team.....	Light & Sound
Sue Vickers and Ray Talbot.....	Props
June Pearce.....	Prompter
Andy Culley and Debbie Masling.....	Costumes
Sandra Jeans.....	Costume Research and Design
Debbie Masling.....	Make-up
Martin Grinter and David Brawn.....	Visuals
Joyce Parson and Lynne Glover.....	Publicity and Marketing
Peter Grainger.....	Publicity Photographs
Andrew Laver.....	Publicity Design
Lynne Glover and team.....	Front of House
Chris Flippance, Nigel Jones and team.....	Car parking
Refreshments.....	Friends of the Players
First Aid.....	Friends of the Players

## The Music

The musical interludes are provided by the Charlton Consort (Carol Davies, Gwillam Davies and Geoff Ramshaw) and use popular tunes of the mid-nineteenth century.

## The Visual Images © Aylwin Sampson

We are very grateful for the use of images of Cheltenham by "Sam" - who is an author, artist and local historian.

## Acknowledgements

Our sincere thanks go to -  
 St Edward's School..... Performance and Rehearsal Space  
 Blend, Charlton Pharmacy & Second Wind..... Ticket Sales  
 Cheltenham Scottish Society..... Loan of the swords  
 Barry Curl..... Production Photographs

And all the friends of the Players who have loaned costumes or props, or who have supported the Players in any way.

## Let Us Be Merry

**Christmas Show**  
**4th December 2013**  
 7:30pm Sacred Hearts Hall

Further details and performance dates will be available nearer the time. Please check our website for regular updates on all of our upcoming performances.

[www.charltonkingscommunityplayers.com](http://www.charltonkingscommunityplayers.com)

## Charlton Kings Community Players



# "The Rivals"

by Richard Brinsley Sheridan  
 Produced and Directed by Martyn Fry and Tony Jeans

**Thursday 24th, Friday 25th &  
 Saturday 26th October 2013**

7.30pm

St Edward's School, Cirencester Road, Performance Hall

## "The Rivals"

by Richard Brinsley Sheridan  
 Produced and Directed by Martyn Fry and Tony Jeans

(First performance - COVENT GARDEN THEATRE in 1775)

**Time and Place**  
 - One day in Cheltenham around 1850.

**Act 1 Scene 1 - Royal Well**  
*Meetings.*

**Act 1 Scene 2 - A dressing room in Mrs Malaprop's lodgings**  
*Plans are set out.*

**Act 2 Scene 1 - Captain Absolute's lodgings**  
*Upset*

**Act 2 Scene 2 - The Promenade**  
*Messages are exchanged*

**Act 3 Scene 1 - The Promenade**  
*Reconciliation*

**Act 3 Scene 2 - Julia's dressing room**  
*More upset*

**Act 3 Scene 3 - Mrs Malaprop's lodgings**  
*Deceit*

**Act 3 Scene 4 - Bob Acres' lodgings**  
*Valour is embraced*

**INTERVAL**

**Act 4 Scene 1 - Bob Acres' lodgings**  
*A duel is arranged*

**Act 4 Scene 2 - Mrs Malaprop's lodgings**  
*Confusion*

**Act 4 Scene 3 - The Promenade**  
*Another duel is arranged*

**Act 5 Scene 1 - Julia's Dressing Room**  
*Distress*

**Act 5 Scene 2 - Royal Well**  
*Action*

**Act 5 Scene 3 - Pittville Park**  
*Resolution*

**Julia's Epilogue**

## CAST in order of appearance

THOMAS - servant to Sir Anthony Absolute.....	Tim Masling
FAG - servant to Captain Absolute.....	John Palmer
CAPTAIN JACK ABSOLUTE - in pursuit of Lydia Languish while masquerading as "Ensign Beverley".....	Michael Robson
LUCY - servant to Mrs Malaprop and Lydia Languish and a go-between.....	Alison Talbot
LYDIA LANGUISH - an heiress, keen on romantic fiction and passionate about "Ensign Beverley".....	Bethie Connor
MAID - at Mrs Malaprop's lodging.....	Deb Masling
JULIA MELVILLE - a sensible young woman, cousin of Lydia.....	Melody Davies
Mrs MALAPROP - a widow with strong moral views. Her use of language is extravagant but inaccurate.....	Jane Jones
Sir ANTHONY ABSOLUTE - Jack's father. He is a wealthy baronet who likes to get his own way.....	Martyn Fry
FAULKLAND - Jack's friend, in love with Julia.....	Helen Roberts
BOB ACRES - an unsophisticated country gentleman, in pursuit of Lydia.....	Tim Blakey
ERRAND BOY AND SERVANT TO BOB ACRES.....	Molly Powell
Sir LUCIUS O'TRIGGER - an Irish gentleman of high honour but poor finance.....	Geoff Ramshaw
Mrs PICKLE - housekeeper to Bob Acres.....	Sue Drinkwater
JULIA'S MAID.....	Sylvia Fry

For biographies of the cast, please visit the Players' web site:  
[www.charltonkingscommunityplayers.com](http://www.charltonkingscommunityplayers.com)

















Publicity shots were taken at St. Edward's school as the house and lawns made the perfect backdrop.  
© Peter Grainger

## Biographies of the Directors/Producers and the Cast

### The Directors/Producers – Martyn Fry and Tony Jeans

**Martyn** is a very experienced actor, director and producer and a Founder Member of the Players. Amongst his many roles, he starred as Capt. Von Trapp in 'Sound of Music' (his favourite) and as The Marshall in 'A Man for this Season'. In this production, he also takes on the lead role of Sir Anthony Absolute.

**Tony** has worked in production for the Players since 2000. He has also written sketches for 'Let Us Be Merry' and the Street Theatre for the Good Friday 'Walk of Witness'. Tony stayed backstage until in 2013 when he was persuaded to take the role of Joseph in 'A Man for This Season'.

This is the third "Classic" drama for the Players that Martyn and Tony have created, following 'Murder in the Cathedral' in 2004 and 'A Midsummer Night's Dream' in 2008.

**Mike Robson** has lots of technical production experience with various companies. This is his first starring role (as the dashing Captain Jack Absolute) for the Players.

**Jane Jones** Previous work with The Players involved Production, Stage Management and Props for a variety of productions including multiple 'Let Us Be Merrys', 'My Fair Lady', 'Oliver', 'Midsummer Night's Dream', 'Escape', 'A Man for this Season'. Acted in double bill 'That's Life', chorus in 'Murder in the Cathedral', Professor Sound in 'The 39 Steps', and now this!

**Bethie Connor** First experience of The Players was 'My Fair Lady' with several roles including a flower girl, a maid and the chorus. Her second outing was in the one act comedy 'Parentcraft', as part of the 'That's Life' event, where she played an eight month pregnant single mum called Siobhan! Acted in 'Fame' with Stage Experience and numerous school productions including 'Bugsy Malone' and 'Romeo and Juliet'.

**Helen Roberts** is a very experienced performer and has taken major parts in productions for a number of companies in Cheltenham. Roles for the Players include Titania in 'A Midsummer Night's Dream' and Rose in 'The Parcel'. In 'A Man for This Season', Helen gave an unforgettable performance as Marie/Mary Magdalene and now in this production she takes on a "trouser" role as Faulkland.

**Melody Davies** This is Melody's first production with the Players. She has performed in many shows with the Cheltenham Operatic and Dramatic Society, usually as a dancer, including 'Singin' in the Rain,' 'South Pacific' and 'Sweet Charity.' Her most recent acting role was as Annelle in 'Steel Magnolias.' She is delighted to be in a show that doesn't start with 's'!

**Tim Blakey** First performed with the Players in the early noughties as Sandy Tyrell in Noel Coward's 'Hay Fever'. Despite enjoying the experience greatly it was ten years before he performed with the Players again in 'Parent Craft' as Derek Coxhead.



# The Production

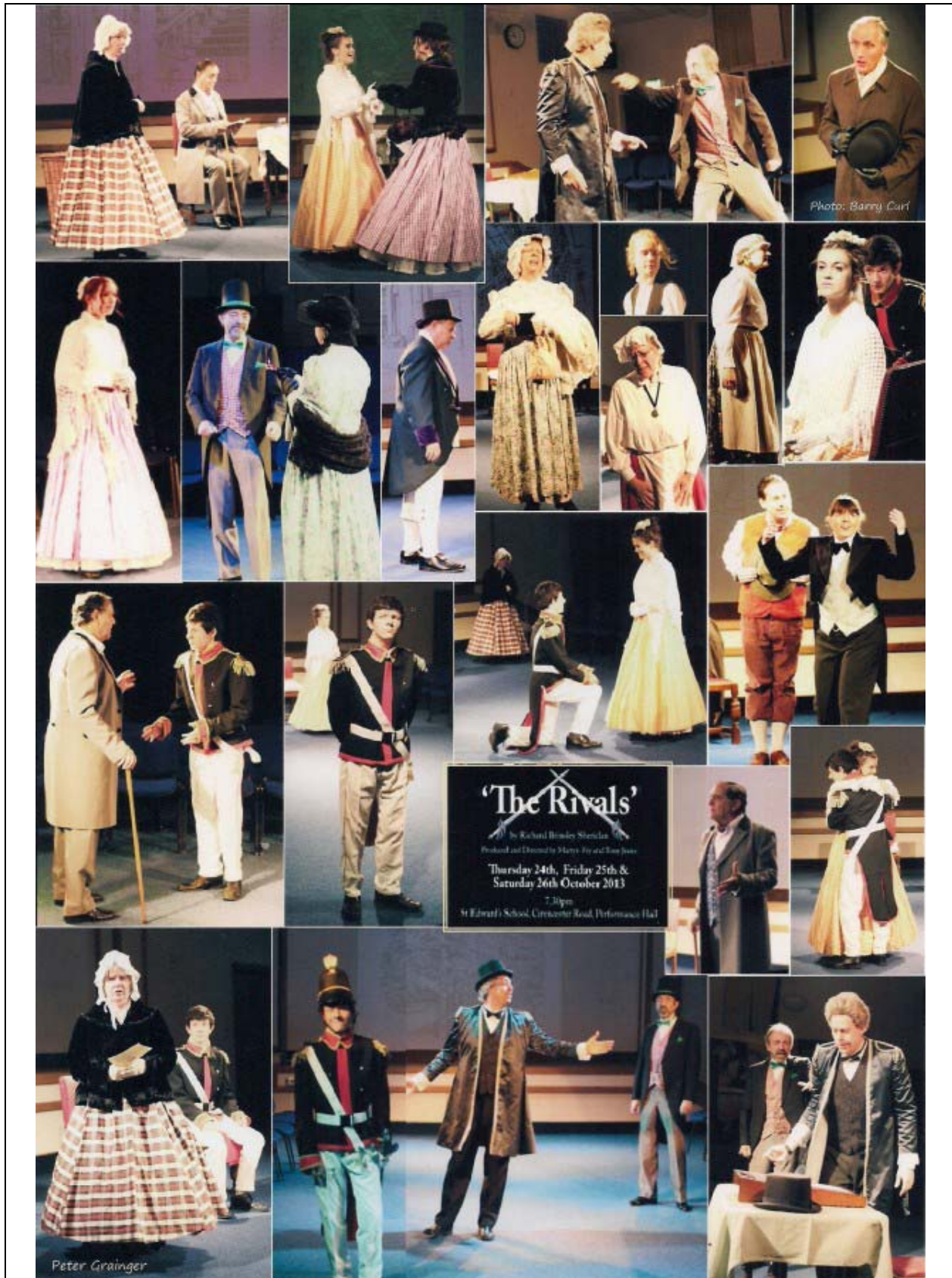





Cast of *'The Rivals'* – Ladies in front



Cast of *'The Rivals'* – Men in front



*Left to right: 'Mrs Malaprop' (Jane Jones);  
 'Captain Jack Absolute' (Michael Robson); '  
 Sir Anthony Absolute' (Martyn Fry)*



*Left to right: 'Lydia Languish' (Bethie Connor),  
 'Faulkland' (Helen Roberts),  
 'Julia Melville' (Melody Davies).*





*Left to right: 'Lucy' (Alison Talbot);  
'Bob Acres' (Tim Blakey);  
'Mrs. Pickle' (Sue Drinkwater).*



*Left to right: 'Thomas' (Tim Masling),  
'Errand Boy and servant to Bob Acres' (Molly Powell);  
'Fag' (John Palmer).*



*Left to right: 'Sir Lucius O'Trigger' (Geoff Ramshaw) with 'Bob Acres' (Tim Blakey);  
'Sir Lucius O'Trigger' (Geoff Ramshaw)*



*'Captain Jack Absolute' (Michael Robson)  
with 'Lydia Languish' (Bethie Connor)  
and 'Sir Lucius O'Trigger' (Geoff Ramshaw).*





Left to right: *'Julia Melville'* (Melody Davies) with *'Lydia Languish'* (Bethie Connor);  
*'Faulkland'* (Helen Roberts) with *'Bob Acres'* (Tim Blakey).



Left to right: *'Mrs Malaprop'* (Jane Jones) with *'Sir Anthony Absolute'* (Martyn Fry)  
 © Barry Curl



*'Julia's maid'* (Sylvia Fry) with  
*'House maid at Mrs Malaprop's Lodgings'* (Debbie Masling)  
 (taken on photo location at St Edward's School - © Peter Grainger)

# Rehearsals – some highlights



Early days in developing the characters





Costume starts to be worn for rehearsals



© Peter Grainger

## Front of House



*Left*  
 Front of House model  
 'Coco Chanel' plays  
 'Delia'  
 (Mrs. Malaprop's  
 adopted name for her  
 letters to Sir Lucius.)

*Right*  
 Sandra Jeans FoH  
 with 'Delia'



© The Revd Ian Browne



# Stage layout with audience on three sides

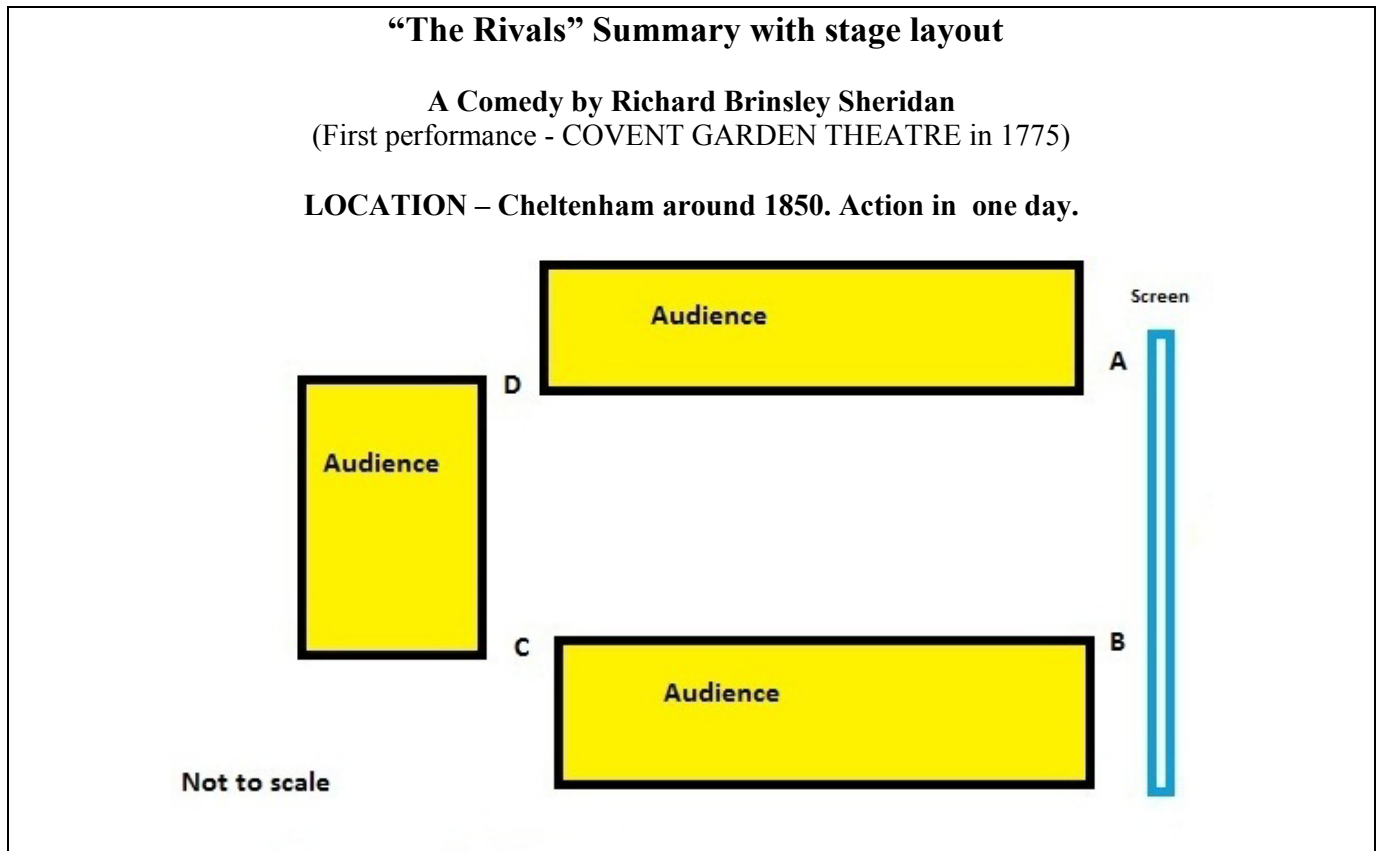

The Visuals were projected on the screen as a backdrop.  
There were minimum props.

## Location of scenes –

- (1) Act 1 Scene 1 – Royal Well
- (2) Act 1 Scene 2 – A dressing room in Mrs Malaprop’s lodgings
- (3) Act 2 Scene 1 – Captain Absolute’s lodgings
- (4) Act 2 Scene 2 – The Promenade
- (5) Act 3 Scene 1 – The Promenade
- (6) Act 3 Scene 2 – Julia’s dressing room
- (7) Act 3 Scene 3 - Mrs Malaprop’s lodgings
- (8) Act 3 Scene 4 – Bob Acres’ lodgings

## INTERVAL

- (9) Act 4 Scene 1 – Bob Acres’ lodgings
- (10) Act 4 Scene 2 – Mrs Malaprop’s lodgings
- (11) Act 4 Scene 3 – The Promenade
- (12) Act 5 Scene 1- Julia’s dressing room
- (13) Act 5 Scene 2 – Royal Well
- (14) Act 5 Scene 3 – Pittville Park

**Curtain Call.**

# The Visuals

© Aylwin Sampson 'Sam' – author, artist and local historian  
Images of Cheltenham used with his permission



Montpellier – used for beginning and interval

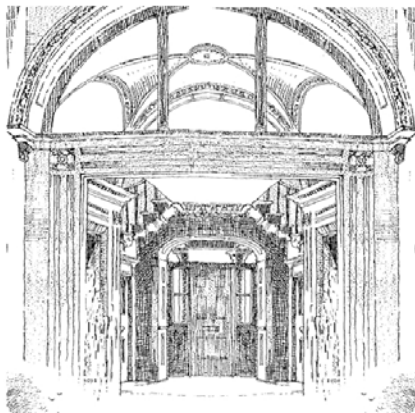

Normandy House – Julia's Lodgings

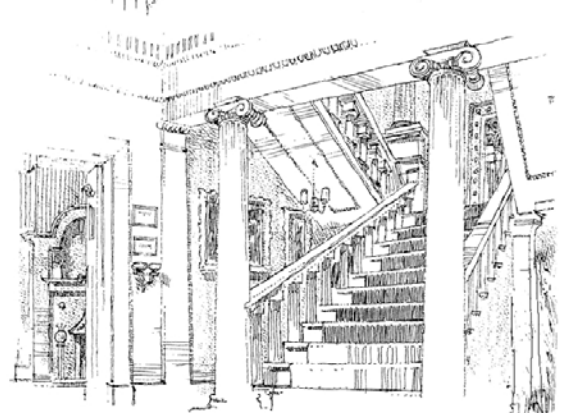

Alma House – Mrs Malaprop's Lodgings



Well Walk – used as Royal Well – meeting place of various characters



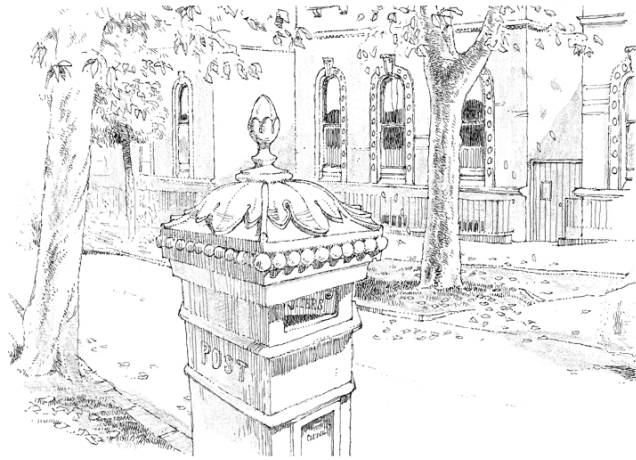

Bayshill – used as The Promenade for encounters of various characters



Pittville Park – used for the duel



Trafalgar Street – view from window of Bob Acres Lodgings

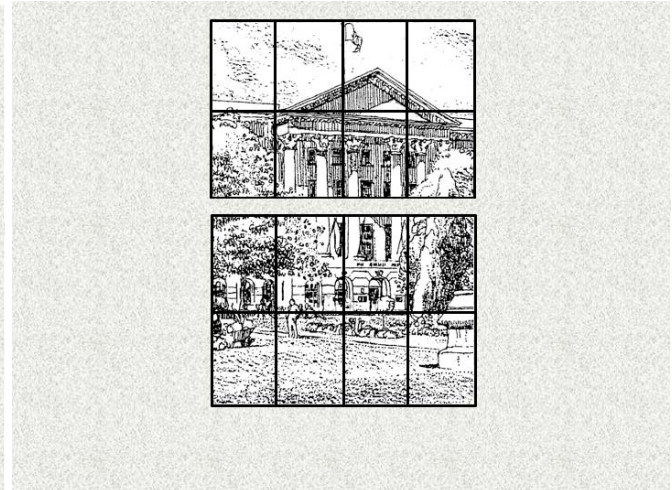

The Queen's Hotel – view from window of Captain Absolute's Lodgings

Original drawings modified with permission to create period.

## Flyers

Charlton Kings Community Players

### “The Rivals”

by Richard Brinsley Sheridan

To be presented on Thursday 24<sup>th</sup>,  
Friday 25<sup>th</sup> and Saturday 26<sup>th</sup> October 2013  
7.30pm at St Edward's Senior School Performance Hall  
Produced and Directed by Martyn Fry and Tony Jeans  
Find more details on the Players' web site  
<http://www.charltonkingscommunityplayers.com/>

Charlton Kings Community Players

### “The Rivals”

by Richard Brinsley Sheridan

To be presented on Thursday 24<sup>th</sup>,  
Friday 25<sup>th</sup> and Saturday 26<sup>th</sup> October 2013  
7.30pm at St Edward's Senior School Performance Hall  
Produced and Directed by Martyn Fry and Tony Jeans  
Find more details on the Players' web site  
<http://www.charltonkingscommunityplayers.com/>

## Press Releases

### Cheltenham stars in a new production

Charlton Kings Community Players' production of *The Rivals* will be performed on Thursday 24th, Friday 25th and Saturday 26th October 2013 at 7.30pm at St Edward's Senior School Performance Hall, (Cirencester Rd). Sheridan's play was originally set in Bath in 1775 but this production locates it in Cheltenham around 1850.

The play is a "comedy of manners" and centres around the romance between Captain Jack Absolute and Lydia Languish. It sends up the conventions, attitudes and behaviour of high (and low) society and includes mistaken identity, the interplay of masters and servants and lots of confusion. An important character is Mrs Malaprop, Lydia's overbearing aunt who doesn't get her words right and so gives rise to the term 'malapropism' ("...an allegory on the banks of Nile")

The action in this production takes place in familiar locations such as The Promenade and Pittville Park. The set will use images of Cheltenham which are the creation of Aylwin Sampson – "Sam" - the celebrated author, artist and local historian. Sam is well known for his books on Cheltenham and Gloucestershire People and Places and for the lectures he gives on the subject locally and further afield.

The cast ranges in age from teenagers to senior citizens and introduces some new performers to the Players in addition to well established actors.

In providing the costumes for the ladies, we have been able to use a number of vintage Laura Ashley styles which were inspired by the Victorian age. This is the 60<sup>th</sup> Anniversary year of Laura Ashley design and production and we have been able to purchase early blouses, dresses and skirts from the internet and charity shops.

We have also been successful in obtaining original Victorian bonnets and mop caps from internet auctions.

Tickets at £7.50 for adults and £5 for children aged 16 or under are available from Blend Coffee Shop, Charlton Pharmacy, Second Wind and on the door. To request tickets, phone 01242 524715 or 517719. For more information on the Production, contact the producers/directors Martyn Fry 01242 239903 or Tony Jeans 01242 820409

**Note for Editors** – see also web site <http://www.charltonkingscommunityplayers.com/>  
**Charlton Kings Community Players** (CKCP) drama group was set up in March 1992 to "*encourage faith, fun and fellowship through ecumenical involvement in a variety of drama and musical activities for all ages.*" It is a voluntary unincorporated community organisation with open membership through participation in artistic activities. It is not a 'club'. It is linked



to and supported by the Churches of Charlton Kings, but participation is unrestricted by individual personal beliefs.

Members of the Players are drawn from anyone in the community who has links to the churches, lives, works, attends school in Charlton Kings, or has strong connections with the village. All productions have open auditions and encourage participation by people of all ages. The productions offer opportunity for involvement in drama, music, dance, lighting, back stage operations, production design, costume, promotion and other aspects of the performing arts.

### **Productions in 2013 have been :-**

“Let us be Merry – *Winter Gifts*” in January consisting of sketches, readings, musical items and seasonal songs;

“A Man for this Season” in April - a contemporary Passion Play written and produced by Peter Grainger, a member of the Players;

A Double Bill of One Act Plays – “The Thirty Nine Steps” and “The Ghost Train” in August. Past productions have included “My Fair Lady”, “Oliver” “, “A Midsummer Night’s Dream”, and “Murder in the Cathedral”.

## **Bonnets from ebay**

Charlton Kings Community Players are rehearsing for their next production, Sheridan’s *The Rivals*. The play was originally set in Bath in the 1780s but this production locates it in Cheltenham around 1850.

One of the Production Team, who has been researching the costumes for the play’s setting, explains , ‘I happened to be looking for items on eBay, and was attracted by news of a current auction of bonnets and mop caps. It was a wonderful surprise to discover some splendid original ones for which I was able to bid successfully.’



*The Rivals* will be performed on Thursday 24th, Friday 25th and Saturday 26th October 2013 at 7.30pm at St Edward’s Senior School Performance Hall, (Cirencester Road). Tickets at £7.50 for adults and £5 for children aged 16 or under are available from Blend Coffee Shop, Charlton Pharmacy and Second Wind. or phone 01242 524715 or 517719. For more information on the Production, contact the producers/directors Martyn Fry 01242 239903 or Tony Jeans 01242 820409

## Communications after Show

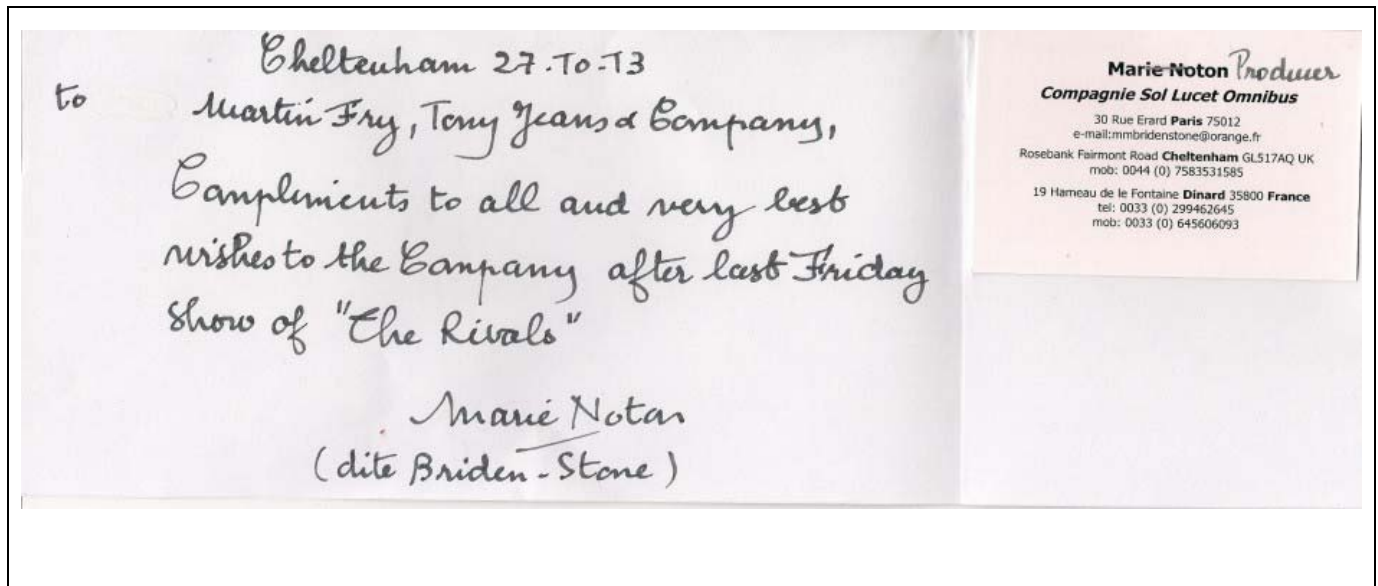

## Director's piece in CKCP Newsletter December 2013

### In support of the team

### *The Rivals*

When Tony and I first discussed the production of this play a few years ago little did I wonder just how superb it would be. That it was so is largely due to a number of factors:

Firstly Tony's unbounded enthusiasm and encouragement for the whole procedure; I certainly could never have managed without him

Secondly the marvellous support we both had from the team

The cast, all were magnificent in learning their lines, their portrayal of their characters; their interpretation of their roles and for attending at all the rehearsals; it made my role as director so much easier. They really are to be complemented on what they achieved.

Thank you Andy Culley and Debbie Masling who managed the Players' costume store so effectively and Sandra Jeans who worked so tirelessly on preparing, making, researching and buying of costumes and accessories from EBay. I am so pleased that a professional commented how good the whole costume design was – richly deserved Sandra.

Sound and Lighting – Peter was excellent in the calm and efficient way in which he managed the whole part of this area of the production – mostly by himself with support from Tony Jeans, David Brawn, Martin Grinter, Ray Talbot and other friends. Not forgetting the wonderful music played and recorded for us by Carol and Gwilym Davies and Geoff



Ramshaw. Peter also augmented and ran the visuals we were so fortunate to have permission to use from local artist and writer, Aylwin Sampson.

Production Team of Derek Palmer and Sue Vickers ably assisted by Ray Talbot who ensured that the sets, the screens behind which the Actors hid, and the movement of furniture and props for each scene were so well set up and smoothly managed.

Our Prompter – how June managed to keep her calm I really don't know particularly as Sir A missed out half a page one night – dress rehearsal I think – Thank you June we were all very happy that you were there it gave us confidence to carry on.

The Publicity and Marketing of Joyce Parsons and Lynne Glover together with Photographs by Peter Grainger and Barry Curl.

Lastly to the whole of the rest of the team, front of house, car parking of Chris Flippance, Nigel Jones and Team; first aid, production team of Fiona Connor and Jane Jones (in addition to her Mrs Malaprop) and to all the Committee so ably led by Debbie Masling who supported Tony and me throughout the whole production. I feel very privileged to have worked with such a wonderful team and I am glad it was so successful.

**Martyn Fry**

---

## Publicity Events

### *CKCP presence at the Charlton Kings Summer fête on Grange Field June 2013*



*Left to right:* Joyce Parsons, Jane Jones and Tony Jeans promote the next production - being *'The Rivals'*. Hats and waistcoats were the order of the day!

*CKCP Stand at the Sacred Hearts' Fayre June 2013*



*Left to right: Debbie Masling Martyn Fry and Helen Roberts in costume.*



*Left to right: Tony Jeans, Debbie Masling and Martyn Fry in costume*

© Sandra Jeans



# Costumes and a particular costume challenge!

Costumes used were from the Charlton Kings Costume store and loaned from personal collections. A number of garments were vintage Laura Ashley with lots of petticoats, and the silk skirts were worn over net or hooped petticoats. Velvets were used for ladies' jackets and cloaks. Such fabrics display well under stage lighting and especially the touches of white.

Items were 'recycled' from previous productions with new adaptations. In particular the uniform jacket worn by Captain Jack Absolute first appeared on stage in '*Les Misérables*' (2004 production). It was then transformed into a simulated uniform. *That Saville Row jacket donated by a supporter will never be the same again!*

## Uniform jacket

Lined tails, trimmed collar, cuffs and lower edge in scarlet silky fabric. Gold soutache added to stand-up collar and cuffs. Gold trimmed epaulettes added. White webbing cross piece has a loop at end for sword (worn in the production for a short time only!). There is a quick release metal click arrangement. Addition of a gold tassel from the button on the piece to 'camouflage' the fitment a little. Holding waist belt has a quick release buckle arrangement (adjustment available).



## Uniform hat

A 19<sup>th</sup> century Shako 'stovepipe' was made from a felt stovepipe with its brim cut off and a peak from a 'baseball' type cap. Leather covering was added to peak and leather trim to the front, including an adjustable chin strap (all from an old handbag). The hackle has been made from swans' feathers and trimmed with gold leaf kid. Buttons, brooch, braid and cord trim added. Addition of small black tassels to side trim.



## The Swords

These were loaned by the Cheltenham Scottish Society. These were ceremonial swords dating back to the Victorian period. The one worn briefly by Captain Absolute was made by a Birmingham manufacturer appointed to the War Office and the India Office (from inscription), and was marked VR (*Victoria Regina*) on the hilt.

